









MONTAGEANLEITUNG

-  MONTAGEANLEITUNG
-  ASSEMBLY INSTRUCTION
-  DE INSTRUCTIE VAN DE ASSEMBLAGE
-  ISTRUZIONI DI MONTAGGIO
-  INSTRUCCIÓN DE ASAMBLEA
-  INSTRUCTION DE MONTAGE
-  NÁVOD K MONTÁŽI
-  MONTERINGSANVISNING

-  MONTAJ TALIMATI
-  ASENNUSOHJE
-  BRUGSANVISNING
-  BRUKSANVISNING
-  UPUTE ZA MONTAŽU
-  NAVODILA ZA MONTAŽO
-  SZERELÉSI ÚTMUTATÓ
-  INSTRUCTIUNI DE MONTAJ





Modell-Nr.

12570

ART.-NR. FRONT KORPUS

12572  Silber
Rot (ähnl. RAL 3002)

12577  Silber
Ultramarinblau (RAL 5002)

12576  
Silber Schwarz (RAL 9005)

Friedrich Küpper GmbH
Friedrich-Küpper-Weg
54570 Berlingen
Deutschland

Telefon +49 (0) 65 91 - 95 42 0
Telefax +49 (0) 65 91 - 95 42 17
E-Mail info@friedrich-kuepper.de
Internet www.friedrich-kuepper.de

EINZELTEILE / PIECES

2× **A**

772 mm × 475 mm

Art.-Nr. E0154 (Silber/silver)
Art.-Nr. E0155 (Schwarz/black)



2× **B**

772 mm × 475 mm

Art.-Nr. E0165 (Silber/silver)
Art.-Nr. E0166 (Schwarz/black)



2× **C**

548 mm × 473 mm

Art.-Nr. E0173 (Silber/silver)
Art.-Nr. E0172 (Schwarz/black)



2× **D**

548 mm × 473 mm

Art.-Nr. E0173 (Silber/silver)
Art.-Nr. E0172 (Schwarz/black)



2× **E**

474 mm × 480 mm

Art.-Nr. E0194 (Silber/silver)



1× **K**

403 mm × 468 mm

Art.-Nr. E0230 (Silber/silver)
Art.-Nr. E0227 (Rot/red)
Art.-Nr. E0229 (Blau/blue)



1× **L**

400 mm × 25 mm

Art.-Nr. E0233 (Silber/silver)
Art.-Nr. E0234 (Schwarz/black)



6× **J**

450 mm × 120 mm

Art.-Nr. E0224 (Silber/silver)



6× **X**

450 mm × 20 mm

Art.-Nr. E0252 (Schwarz/black)



6× **H**

450 mm × 445 mm

Art.-Nr. E0215 (Silber/silver)



6× **I**

470 mm × 130 mm

Art.-Nr. E0221 (Silber/silver)
Art.-Nr. E0218 (Rot/red)
Art.-Nr. E0220 (Blau/blue)



1× **Y**

1700 mm × 600 mm

Art.-Nr. E0257 (Silber/silver)



1×



20 mm × 55 mm

Art.-Nr. E0951

BEUTELINHALT / BAG CONTENT

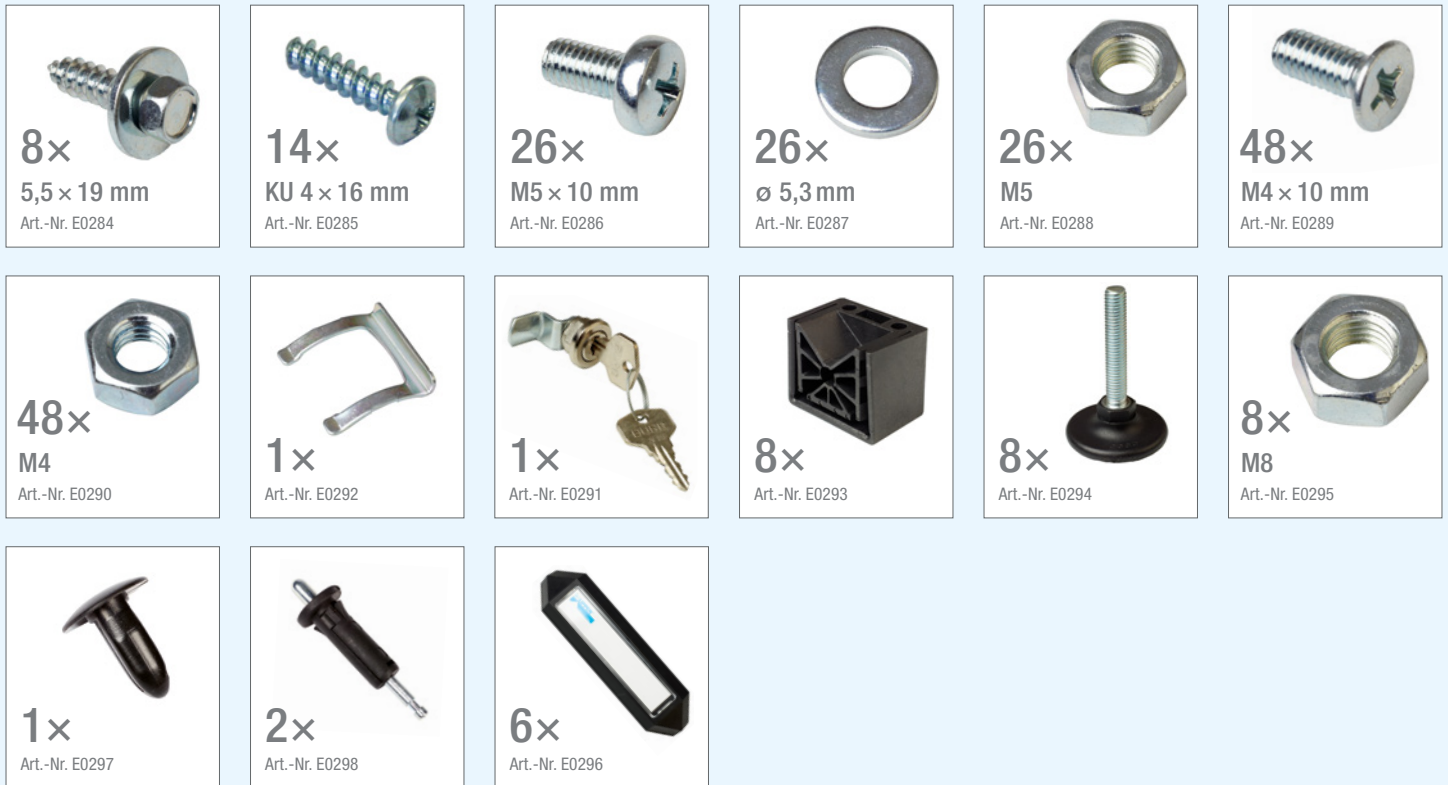

BENÖTIGTES WERKZEUG / NEEDED TOOLS

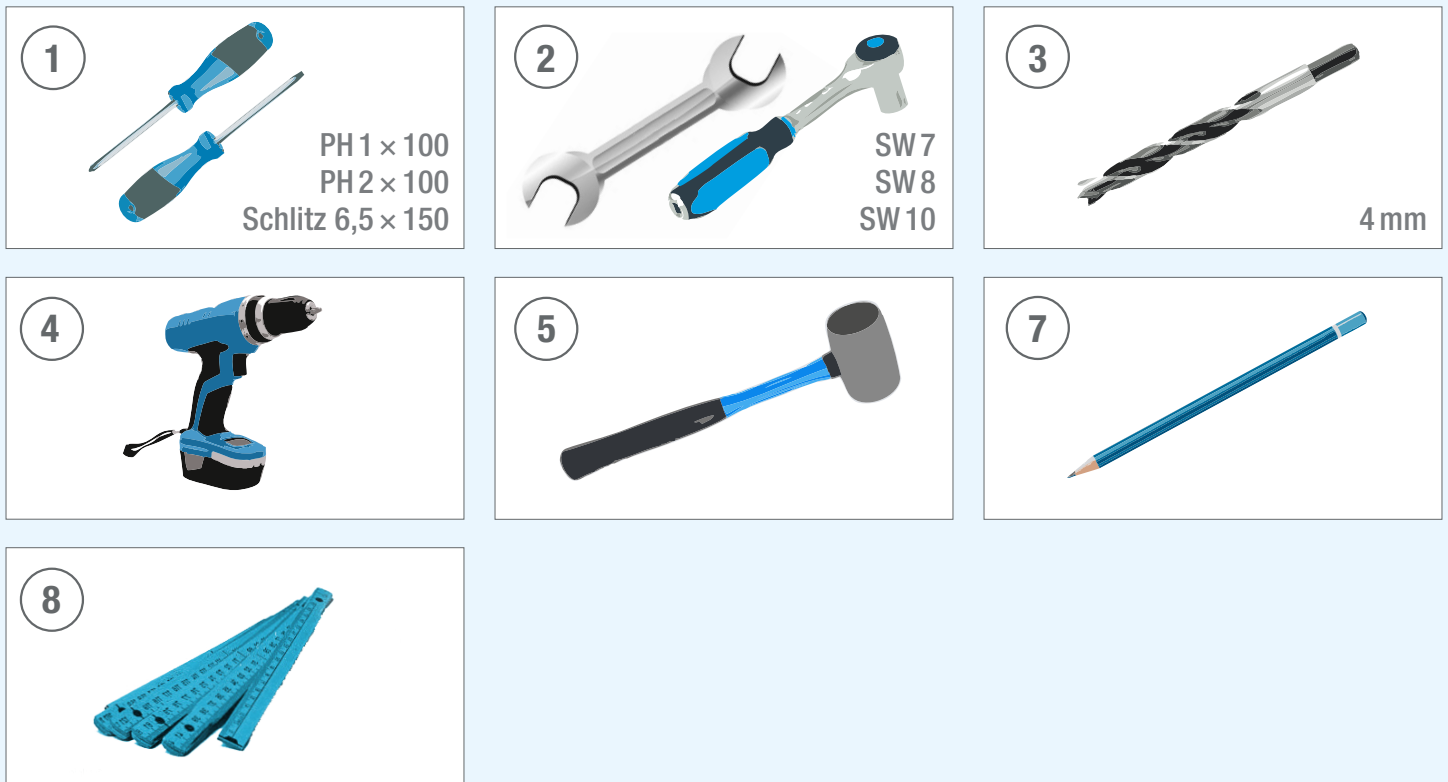

1.  2x M5  2x M5x10  2x 5,3MM

 2 SW8  1 PH2x100

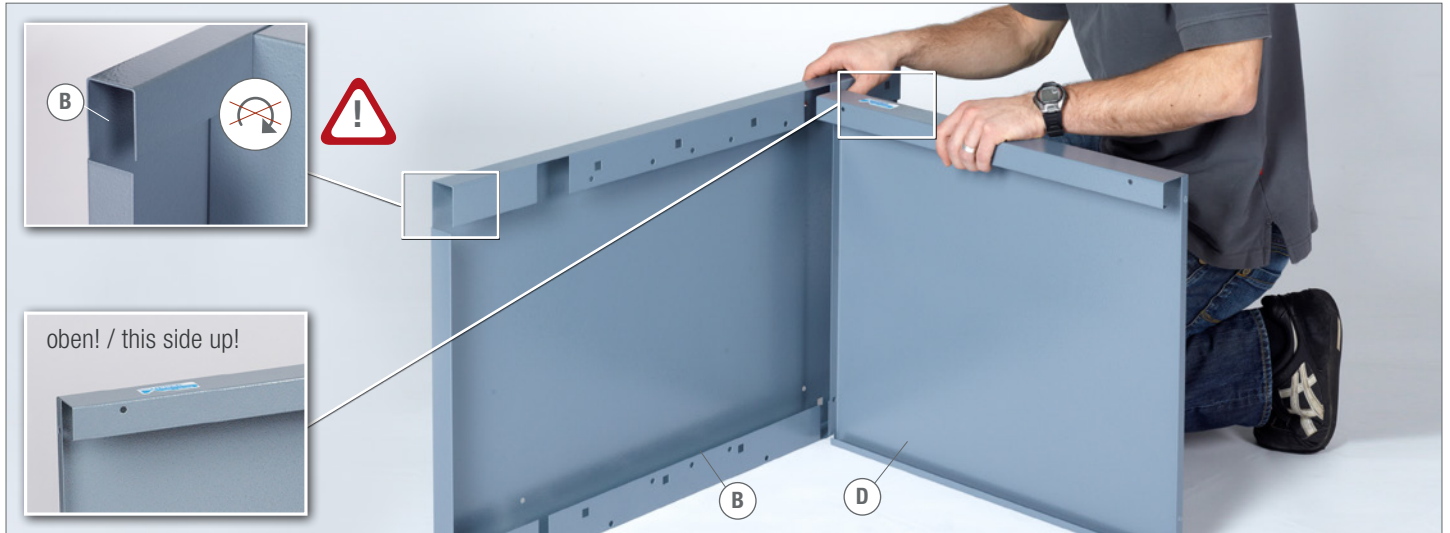

2.  2x M5  2x M5x10  2x 5,3MM

 2 SW8  1 PH2x100



3. 2x M5 2x M5x10 2x 5,3MM

② SW8 ① PH2x100



4. 6x M5 6x M5x10 6x 5,3MM

② SW8 ① PH2x100



5. 4x M8 4x 4x 4x

⑤



WIEDERHOLEN SIE DIE SCHRITTE 1 – 5 / REPEAT STEPS 1 – 5

6.

2 × KU4 × 16



1 ×

①

PH2 × 100



7.

6 × CL

6 × CR



8.



9.

12x M4

12x M4 x 10

② SW7

① PH1 x 100

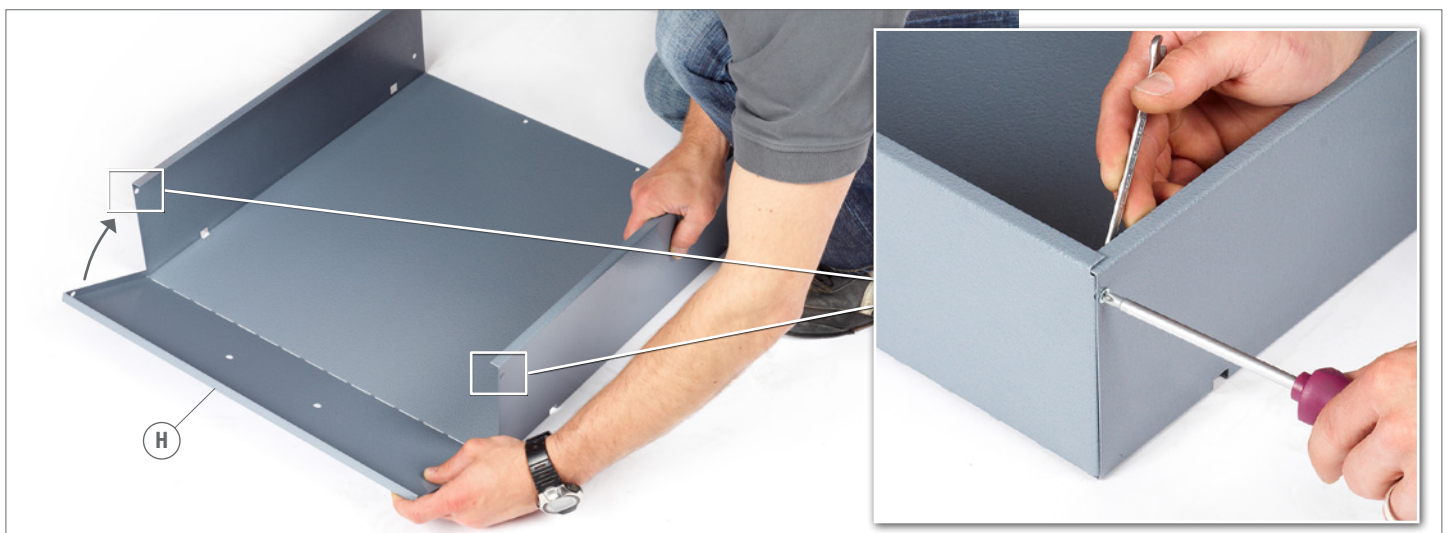

10.

36x M4 36x M4 x 10

② SW7 ① PH1 x 100

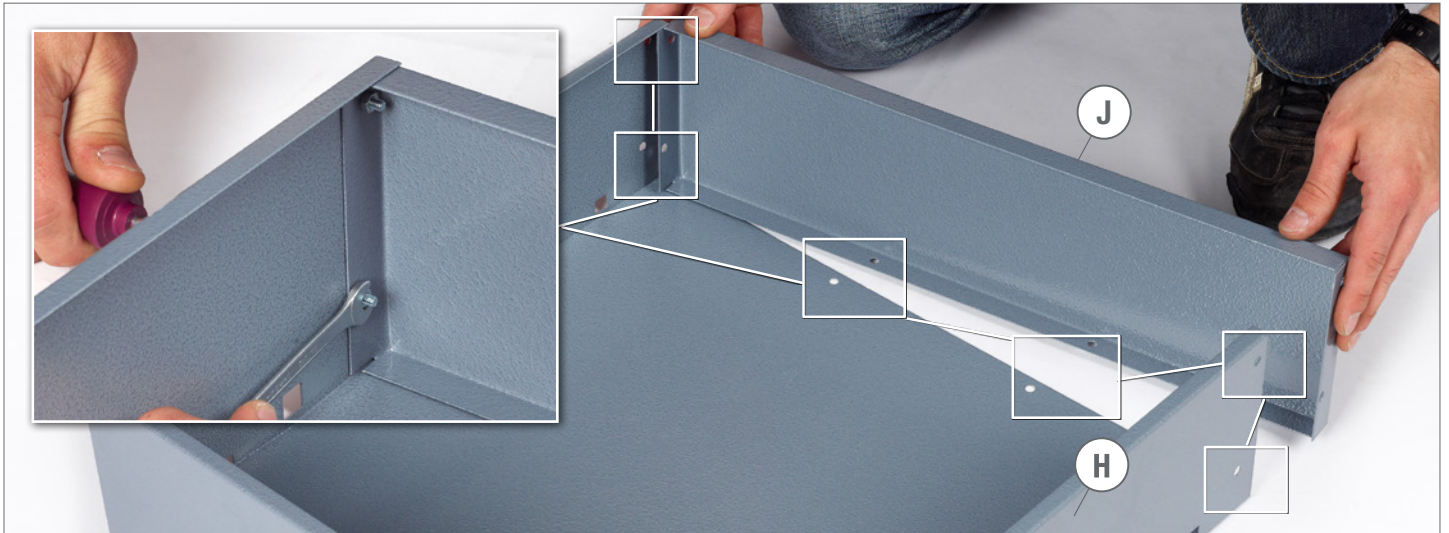

11.

6x DL 6x DR

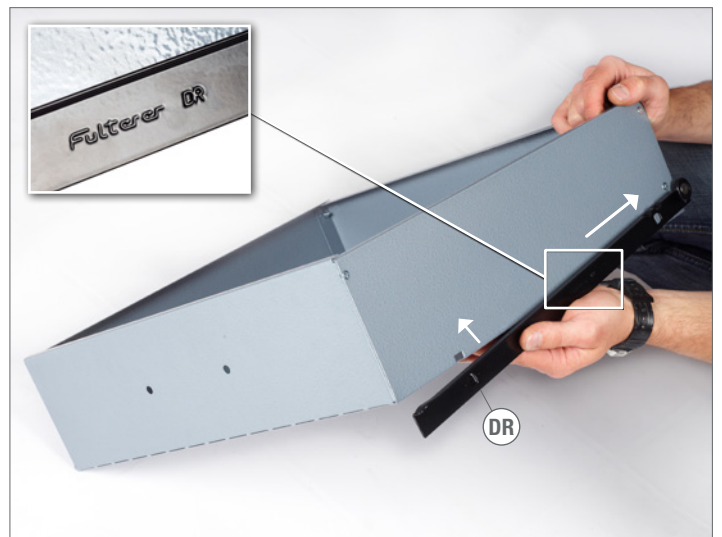
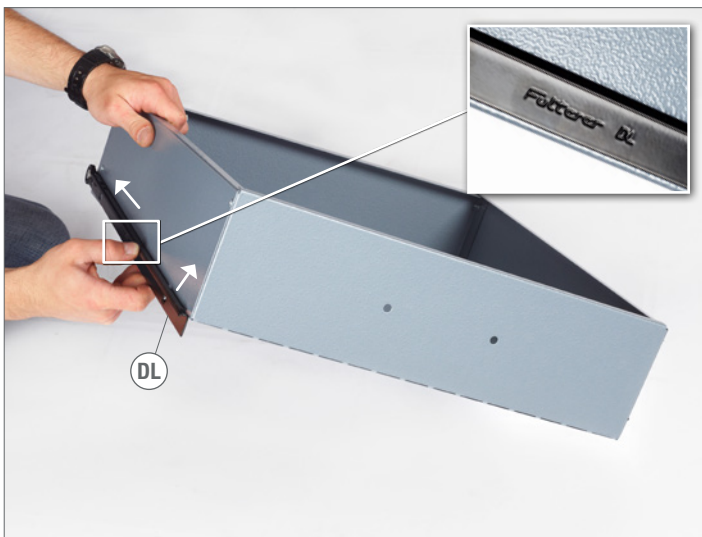

12.

12x KU4x 16 6x

① PH2 x 100



13.



14.



15.



16.

8 x 5,5 x 19



17.



18.



19.



20.



21.





Modell-Nr.

12570